



# Service poles, office

The slender and flexible solution for  
supply points at the workstation

**OBO**  
BETTERMANN

# ISS service pole systems

## Maximum flexibility – not just at the workstation

In modern offices, technology must be completely flexible and also aesthetically pleasing. The solution: OBO's service pole systems. They allow free positioning of power supply points near workstations. The location can be changed at any time. This gives both users and architects the greatest possible freedom.

In open-plan offices and administrative buildings, as well as in cash desk areas of shops or in production facilities, they provide more order. ISS service pole systems fulfil all the technical and architectural requirements of modern cable routing and make an active contribution to the interior architecture.



# Selection criteria

## How to find the right pole

### Application

#### Floor service poles

These poles are mounted directly onto the floor and supplied from below, e.g. through an underfloor system or through cavity/raised floors.

#### Floor to ceiling service poles

The poles can be positioned anywhere in the room. The poles are braced against the ceiling using a clamping device to ensure a secure hold. This is concealed by the false ceiling.

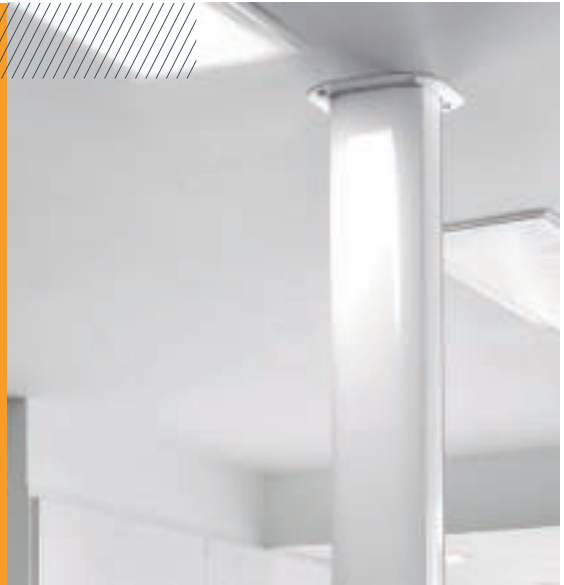

### Requirements

#### Number of installation devices

When choosing the correct service pole, it is important to specify the number of switching and connection devices in order to determine the installation space. For example, a 2-compartment service pole, such as the ISS140110, provides a large amount of installation space.



### Design

#### Round and oval, square or rectangular

The OBO ISS service pole range offers a solution for any design. The service poles, primarily available in white or aluminium anodised designs, are available on request in all possible RAL shades.



# Service pole, type 80

## The space-saving solution

Service poles with an 80 mm system opening are fitted with accessory mounting boxes and mounting supports to accept sockets, data sockets, etc., which allow the universal use of any brand. The benefits of OBO's own Modul 45 system can be seen, for example, in the space-saving installation.



### Fitting on both sides

Both sides are made of an identical aluminium profile. Here, two profiles are interconnected, meaning that they can be fitted on both sides. In both cases, there is also generous installation space for standard devices.

The compact design of the Modul 45 devices allows more switching and connection devices to be housed in the intended installation area than the standard devices with a support ring or support clamp design.



06 LFS Broschüre Installationssäulen Büro 2020 / en / 2020/09/02 10:04:01 10:04:01 (LLExpert\_02770) / 2020/09/02 10:05:40 10:05:40

# Service pole, type 45

Ready for anything

## Clamping device

The service poles are fixed between floor and ceiling using a clamping device.

## More flexibility

Poles with a floor plate and flexible hose to the ceiling can be moved in a specific radius and can thus be adapted to meet changing requirements. All kinds of devices can be mounted using OBO's own Modul 45 series.



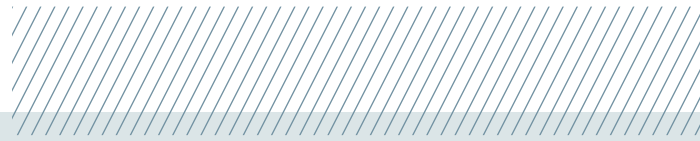

#### Mounting of the service pole

With these ISS service poles, fastening takes place on the floor. The cables are run to the pole through the underfloor system or cable protection pipes.

A profile, which can be fitted on both sides, is available for more flexibility during installation. The profile is equipped with a 45 mm system opening. In this way, the devices of the Modul 45 series can be integrated directly into the pole profile.

# Two-compartment aluminium service pole, type ISS130130

Flexible usage in spaces with different ceiling heights

## Simple – straightforward – safe

These three design principles formed the guideline for the development of the new clamping device.

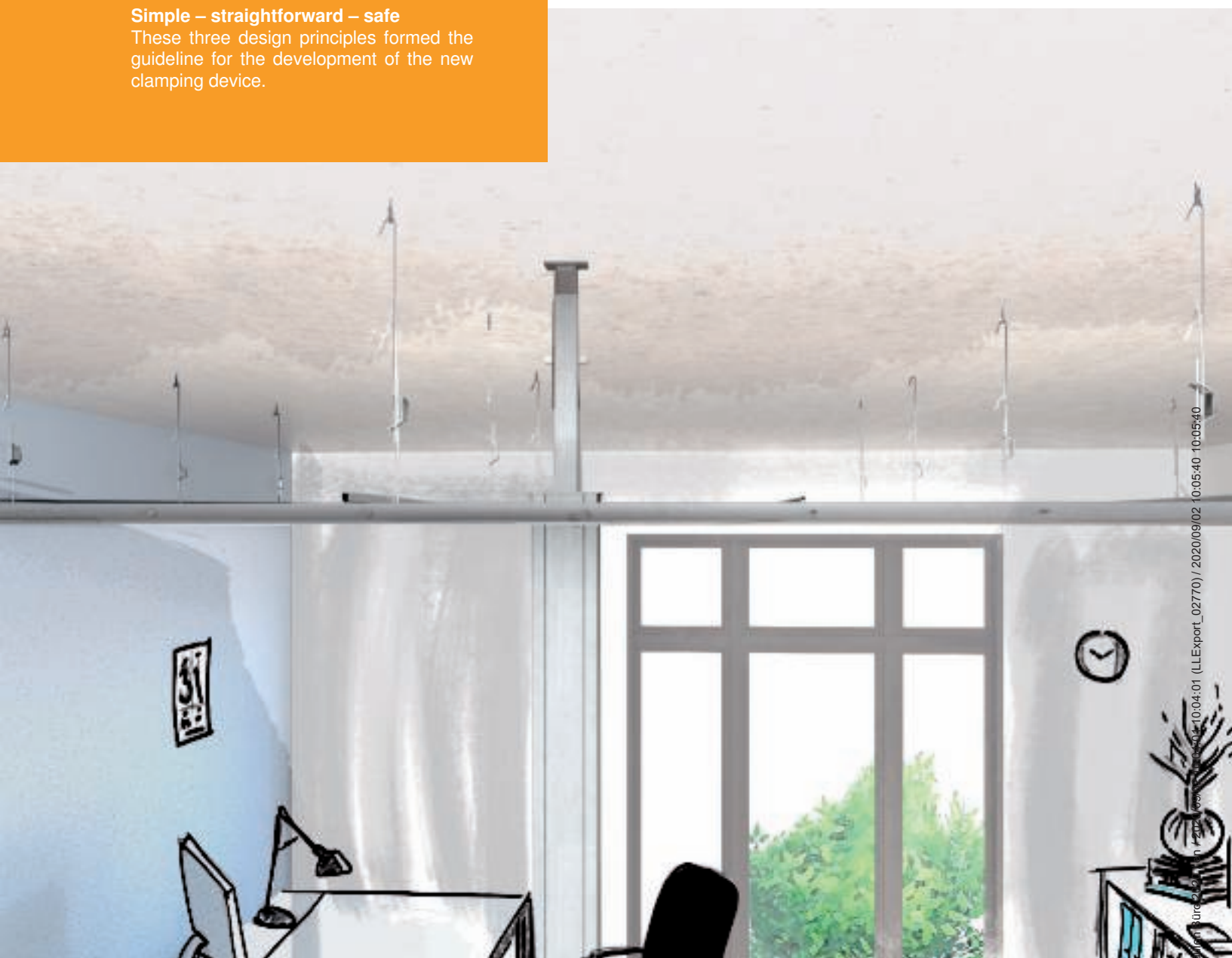





#### Simple

With the new ISS130130, the principle of the clamping device is based on a self-locking spindle drive. The force for the clamping procedure is applied with a standard tool. The movement of the tool transfers the clamping force to the ceiling and floor.

#### Straightforward

A pointer indicates to the installer when the clamping force required by the standard has been reached, in order to guarantee the secure positioning of the column.

#### Safe

The clamping device is positioned outside the field of view, protected against access.

# Floor to ceiling service poles



## ISS70110ST... Floor to ceiling service pole

- Made of sheet steel
- Simple clamping device
- Cover made of either PVC or sheet steel

## ISST70140B... Floor to ceiling service pole

- Made of aluminium
- Two pipe profiles running in parallel, with 1,000 mm installation area

## ISSOG70140... Floor to ceiling service pole

- Made of closed oval aluminium profile

## ISS70110..., ISS140110.... Floor to ceiling service pole

- 1 or 2-compartment
- Aluminium profile corresponds to the GA70110... device installation trunking



**ISS130130... Floor to ceiling service pole**

- 2-compartment ISS with 80 mm system opening
- Square design
- Clamping device can be used up to 1,500 mm over pole body

**ISSRM45.... Floor to ceiling service pole**

- 1-compartment
- Slender, round aluminium profile with 70 mm diameter
- 45 mm system opening for direct installation of Modul 45 devices

**ISSDM45.... Floor to ceiling service pole**

- 2-compartment
- Slightly oval-shaped aluminium profile with 2 opposing 45 mm system openings

**ISS110100..., ISS140100.... Floor to ceiling service pole**

- 2-part aluminium pipe profile with 80 mm diameter
- 1 or 2 780 mm-high extension tanks with an 80 mm system opening for device installation

# Floor service poles

Perfectly matched to your requirements



06 LFS Broschüre Installationssäulen Büro 2020 / en / 2020/09/02 10:04:51 / 01 (LExpert\_02770) / 2020/09/02 10:05:40 10:05:40



**ISSHS140250... Floor service pole**

- 2 opposing 80 mm system openings, device installation
- Height 250 mm

**ISSHS140500 Floor service pole**

- 2 opposing 80 mm system openings, device installation
- Height 500 mm

**ISSHS140700 Floor service pole**

- 2 opposing 80 mm system openings, device installation
- Height 675 mm

**ISSHS6 Service pole centre**

- 4 sides with 6 x 80 mm system openings
- Can be fitted on all sides
- Height 564 mm



**ISSHS4... Floor service pole**

- Made of sheet steel
- Can be fitted on 4 sides, with 80 mm system opening
- Height 680 mm

**ISSOGHS70140... Floor service pole**

- Slender, oval aluminium profile with 80 mm system opening
- Height 675 mm

**ISSRHSM45... Floor service pole**

- Slender, round 70 mm aluminium profile with single-sided 45 mm system opening
- Height 675 mm

**ISSDHSM45... Floor service pole**















- Made of aluminium with 2 opposing 45 mm system openings for the installation of Modul 45 devices
- Height 675 mm

# Modul 45 devices

One system – many options



06 LFS Broschüre Installationsäulen Büro 2020 / www.oetiker.com / 0049 42 10064 01 1000 / 0049 42 10064 01 1000 / 2020/09/02 10:05:40 10:05:40

	0° socket, single
	0° socket, double
	0° socket, triple
	33° socket, double
	33° socket, Connect 45, double
	33° socket, Connect 45, triple
	Changeover key
	Roller blind button
	Cable outlet
	Data technology support, straight outlet
	Data technology support, slanting outlet
	HDMI connection, straight outlet
	Audio cinch connection, straight outlet
	USB charging device



# Mounting information

## Service poles, sheet steel



1

### Clamping service poles

The service pole is tensioned between the ceiling and floor at the stand, using a wrench. The movement of the wrench transfers the clamping force to the ceiling and floor. When the clamping force demanded by the standard has been reached, then the pole is stable.

2

### Connection of the service pole in a false ceiling

With the ISS70110ST, the telescopic profile can be fastened to the ceiling, in order to secure the pole against torsion. The connection cables are fed into the service pole through the top opening of the telescopic profile.

3

### Equipotential bonding

With all steel and aluminium poles, the continuous equipotential bonding between the cover and base is created automatically via the locking brackets in the closing contour. For this reason, at the end of mounting, the pole profile may only be connected to the equipotential bonding via a single earthing point.



# Mounting information

## Service poles with clamping device



1

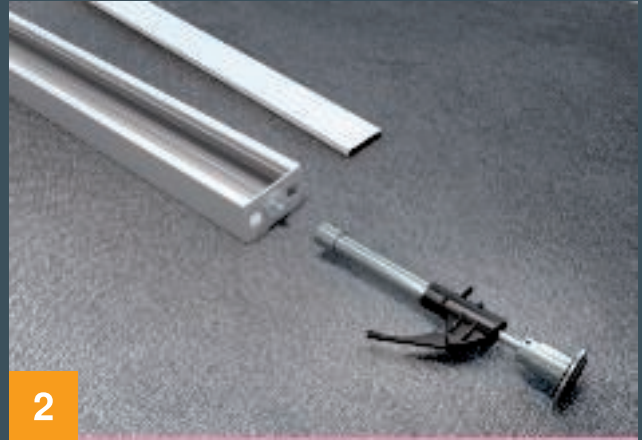

2



3

1

### Screwing the service pole to the floor

If the service pole is to be screwed to the floor, then the existing floor panel can be removed and replaced with a larger floor plate. The service pole can now be fastened to the floor using bolts and anchors.

2

### Mounting of the clamping device

The cover of the service pole is removed and the clamping device screwed on.

3

### Clamping device features

The telescopic clamping device is extended by repeatedly pressing the lever and clamps the pole between the floor and ceiling. Optionally, the clamping device can also be screwed to the ceiling.

# Mounting information

## Service pole with hose to ceiling



1

### Stable stand

The service poles with a hose to the ceiling are fitted with a large floor plate in order to ensure safe and stable positioning.

2

### Variable positioning

Poles with a hose to the ceiling can be moved at a later point within a radius of approx. 1.5 m.

3

### Connecting service poles to a Consolidation Point

The service poles are supplied with data and power cables via the false ceiling. A Consolidation Point is a suitable connection point.

# Mounting information

## Floor service poles



1

### **Screwing the floor service pole to the floor**

The floor service poles are fastened to the floor using bolts and anchors.

2

### **Connecting floor service poles to a raised floor**

The floor service pole can be supplied with power and data cables via a raised floor. A UPS power supply is a suitable connection point.

3

### **Connecting floor service poles to an underfloor system**

The floor service pole can be connected to an underfloor system. Power is fed in through an underfloor box.

Service pole, sheet steel, with sheet steel cover

Type	Colour	Pack Piece	Weight kg/100 pc.	Item no.
ISS70110STRW	Pure white	1	1,121.000	6286530

Si Steel

Sheet steel service pole with a 76.5 mm system opening.

Set consists of:

1 single-compartment pole with clamping fastening

Total length 2,800–3,700 mm

1 ceiling fastening with telescopic profile

1 sheet steel cover

Length: 2,500 mm

A 2 m PVC separating retainer and two cover clips are contained in the scope of delivery.

The service pole is suitable for accepting accessory mounting boxes of the series 71GD...

The service pole is pre-mounted and ready for use immediately. The following accessories can also be used, depending on the mounting situation.

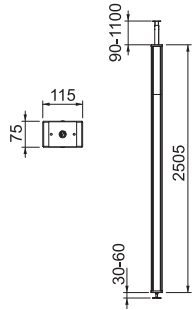

## Service pole, sheet steel, with PVC cover

Type	Colour	Pack Piece	Weight kg/100 pc.	Item no.

St Steel

Sheet steel service pole with a 76.5 mm system opening.

Set consists of:

1 single-compartment pole with clamping fastening

Total length 2,800–3,700 mm

1 ceiling fastening with telescopic profile

1 PVC cover

Length: 2,500 mm

A 2 m PVC separating retainer and two cover clips are contained in the scope of delivery.

The service pole is suitable for accepting accessory mounting boxes of the series 71GD...

The service pole is pre-mounted and ready for use immediately. The following accessories can also be used, depending on the mounting situation.

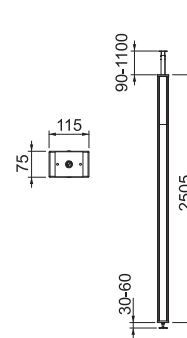

### Cover screen

Type	Colour	Pack Piece	Weight kg/100 pc.	Item no.

St Steel

Cover screen to laminate the ceiling plate cut-out in the gland area of the ISS70110ST service pole.

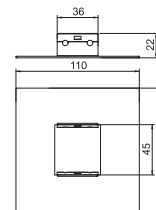

### Clamp fastening

Type	Pack Piece	Weight kg/100 pc.	Item no.

St Steel

FS Strip galvanised

Clamp fastening to fasten the telescopic profile of the ISS70110ST service pole to the support rails of false or suspended ceilings.

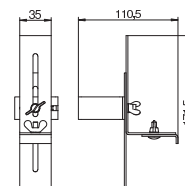

## Service pole, type ISST70140

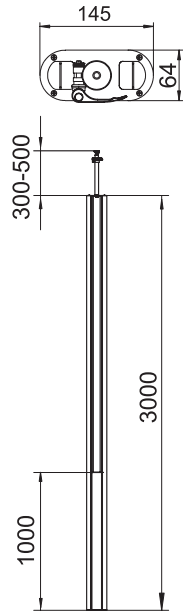

Type	Colour	Surface	Length mm	Pack Piece	Weight kg/100 pc.	Item no.
<b>ISST70140RW</b>	Pure white	—	3,006	1	820.000	<b>6288930</b>
<b>ISST70140EL</b>	—	Anodised	3,006	1	820.000	<b>6288933</b>

**Alu** Aluminium

**EL** Anodised

ISS twin aluminium service pole with a 76.5 mm system opening.

Set consists of:

1 single-compartment column with clamping attachment

Total length: 3,315–3,480 mm

1 single-compartment pole with clamping device

1 trunking installation profile

Length 1,000 mm

1 aluminium cover

Length: 1,000 mm

The area for device installation is suitable for accepting front-locking accessory mounting boxes of the series 71GD...

The service pole is pre-mounted and ready for use immediately. The following accessories can be used, depending on the mounting situation.

## Floor plate for ISSOG70140

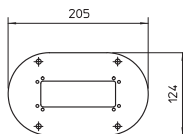

Type	Colour	Pack Piece	Weight kg/100 pc.	Item no.
<b>ISSBP70140RW</b>	Pure white	1	18.500	<b>6290120</b>
<b>ISSBP70140WA</b>	White aluminium	1	18.500	<b>6290124</b>

**St** Steel

**FSK** Strip galvanised/powder-coated

Floor plate with 30 mm visible edge and four fastening holes Ø 8.5 mm. The floor plate is suitable for mounting service poles of type ISST70140, ISSOG70140 and ISST70140B.

## Adapter stabiliser for ISST70140

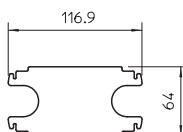

Type	Colour	Pack Piece	Weight kg/100 pc.	Item no.
<b>ISSZ70140</b>	Pure white	1	8.000	<b>6290160</b>

**St** Steel

**FSK** Strip galvanised/powder-coated

Adapter stabiliser for additional stiffening of the twin profiles. Suitable for mounting on the service poles of type ISST70140 and ISST70140B.

### Fastening bracket for ISST70140

Type	Colour	Pack Piece	Weight kg/100 pc.	Item no.
<b>ISSBW70140RW</b>	Pure white	1	8.500	<b>6290150</b>

**St** Steel

**FSK** Strip galvanised/powder-coated

Fixing bracket for wall fastening of the twin service pole. Suitable for installation on the service poles of type ISST70140 and ISST70140B.

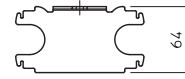
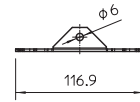

### Rubber support for ISSOG70140

Type	Colour	Pack Piece	Weight kg/100 pc.	Item no.
<b>ISSGU70140</b>	Black	1	5.000	<b>6290174</b>

**GUM** Rubber

Rubber support for slip-free fastening of the floor to ceiling service pole. The rubber support is suitable for installing the service poles of type ISST70140, ISSO70140 and ISST70140B.

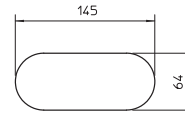

### Ceiling panel for ISST70140

Type	Colour	Pack Piece	Weight kg/100 pc.	Item no.
<b>WAG70140TRW</b>	Pure white	1	28.600	<b>6290200</b>

**St** Steel

Ceiling rosette for tidy closure of the pole penetration in the ceiling. Suitable for service poles, type ISST70140 and ISST70140B.

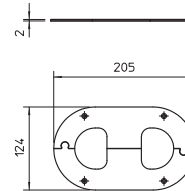

## Service pole, type ISST70140B

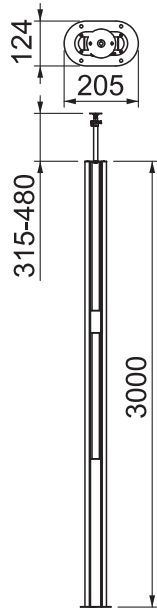

Type	Colour	Surface	Length mm	Pack Piece	Weight kg/100 pc.	Item no.
<b>ISST70140BEL</b>	—	Anodised	3,006	1	860.000	<b>6290013</b>
<b>ISST70140BRW</b>	Pure white	—	3,006	1	860.000	<b>6290010</b>

**Alu** Aluminium

**EL** Anodised

ISS twin aluminium service pole with a 76.5 mm system opening.

Set consists of:

1 single-compartment column with clamp fastening

Total length: 3,315 mm–3,480 mm

1 fastening option for lighting

1 ceiling fastening with clamping device

1 trunking installation profile

Length: 1,000 mm

1 aluminium cover

Length: 1,000 mm

The area for device installation is suitable for accepting front-locking accessory mounting boxes of the series 71GD... The panel to fasten luminaires is attached at a height of 1,850 mm and its own height is 148 mm. It is possible to create various kinds of workplace or general room lighting using the standard wall brackets from lighting manufacturers.

The service pole is pre-mounted and ready for use immediately. The following accessories can be used, depending on the mounting situation.

## Floor plate for ISSOG70140

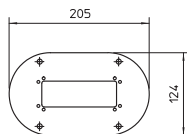

Type	Colour	Pack Piece	Weight kg/100 pc.	Item no.
<b>ISSBP70140RW</b>	Pure white	1	18.500	<b>6290120</b>
<b>ISSBP70140WA</b>	White aluminium	1	18.500	<b>6290124</b>

**St** Steel

**FSK** Strip galvanised/powder-coated

Floor plate with 30 mm visible edge and four fastening holes Ø 8.5 mm. The floor plate is suitable for mounting service poles of type ISST70140, ISSOG70140 and ISST70140B.

## Adapter stabiliser for ISST70140

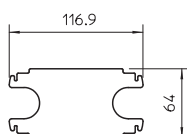

Type	Colour	Pack Piece	Weight kg/100 pc.	Item no.
<b>ISSZ70140</b>	Pure white	1	8.000	<b>6290160</b>

**St** Steel

**FSK** Strip galvanised/powder-coated

Adapter stabiliser for additional stiffening of the twin profiles. Suitable for mounting on the service poles of type ISST70140 and ISST70140B.



### Fastening bracket for ISST70140

Type	Colour	Pack Piece	Weight kg/100 pc.	Item no.
<b>ISSBW70140RW</b>	Pure white	1	8.500	<b>6290150</b>

**St** Steel

**FSK** Strip galvanised/powder-coated

Fixing bracket for wall fastening of the twin service pole. Suitable for installation on the service poles of type ISST70140 and ISST70140B.

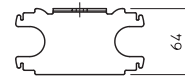
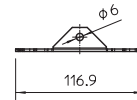

### Rubber support for ISSOG70140

Type	Colour	Pack Piece	Weight kg/100 pc.	Item no.
<b>ISSGU70140</b>	Black	1	5.000	<b>6290174</b>

**GUM** Rubber

Rubber support for slip-free fastening of the floor to ceiling service pole. The rubber support is suitable for installing the service poles of type ISST70140, ISSO70140 and ISST70140B.

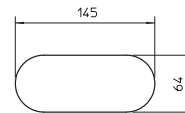

### Ceiling panel for ISST70140

Type	Colour	Pack Piece	Weight kg/100 pc.	Item no.
<b>WAG70140TRW</b>	Pure white	1	28.600	<b>6290200</b>

**St** Steel

Ceiling rosette for tidy closure of the pole penetration in the ceiling. Suitable for service poles, type ISST70140 and ISST70140B.

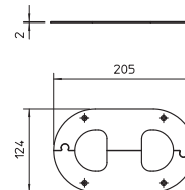

## Service pole, type ISSOG70140



Type	Colour	Surface	Length mm	Pack Piece	Weight kg/100 pc.	Item no.
<b>ISSOG70140RW</b>	Pure white	—	3,006	1	700.000	<b>6289090</b>
<b>ISSOG70140EL</b>	—	Anodised	3,006	1	700.000	<b>6289088</b>

**Alu** Aluminium

**EL** Anodised

ISS service pole, oval shape, aluminium, with a 76.5 mm system opening.

Set consists of:

1 single-compartment column with clamping attachment

Total length: 3,315–3,480 mm

1 single-compartment pole with clamping device

1 trunking installation profile

Length 3,000 mm

1 aluminium cover

Length: 3,000 mm

The area for device installation is suitable for accepting front-locking accessory mounting boxes of the series 71GD...

The service pole is pre-mounted and ready for use immediately. The following accessories can be used, depending on the mounting situation.

## Floor plate for ISSOG70140

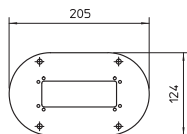

Type	Colour	Pack Piece	Weight kg/100 pc.	Item no.
<b>ISSBP70140RW</b>	Pure white	1	18.500	<b>6290120</b>
<b>ISSBP70140WA</b>	White aluminium	1	18.500	<b>6290124</b>

**St** Steel

**FSK** Strip galvanised/powder-coated

Floor plate with 30 mm visible edge and four fastening holes Ø 8.5 mm. The floor plate is suitable for mounting service poles of type ISST70140, ISSOG70140 and ISST70140B.

## Rubber support for ISSOG70140

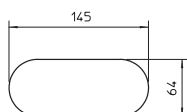

Type	Colour	Pack Piece	Weight kg/100 pc.	Item no.
<b>ISSGU70140</b>	Black	1	5.000	<b>6290174</b>

**GUM** Rubber

Rubber support for slip-free fastening of the floor to ceiling service pole. The rubber support is suitable for installing the service poles of type ISST70140, ISSOG70140 and ISST70140B.

Ceiling rosette for ISSOG70140

Type	Colour	Pack Piece	Weight kg/100 pc.	Item no.
<b>WAG701400</b>	Pure white	1	23.400	<b>6290260</b>

St Steel

Ceiling rosette for tidy closure of the pole penetration in the ceiling. Suitable for service pole, type ISSO70140.

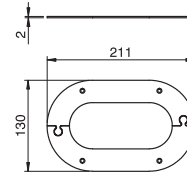

## Service pole, type ISS70110

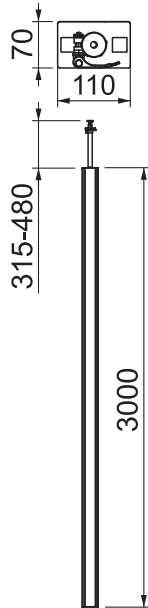

Type	Colour	Surface	Length mm	Pack Piece	Weight kg/100 pc.	Item no.
ISS70110RW	Pure white	—	3,003	1	750.000	6288940
ISS70110EL	—	Anodised	3,003	1	750.000	6288943

Alu Aluminium

EL Anodised

ISS aluminium service pole with a 76.5 mm system opening.

Set consists of:

1 single-compartment pole with clamping fastening

Total length 3,315–3,480 mm

1 ceiling attachment with clamp

1 aluminium cover

Length: 3,000 mm

The service pole is suitable for accepting front-locking accessory mounting boxes of the series 71GD... Optionally, a partition, type TW (6288256), and installation of a cover clip, type KL80A (6288640), are possible.

The service pole is pre-mounted and ready for use immediately. The following accessories can be used, depending on the mounting situation.

## Floor plate for ISS70110

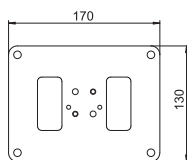

Type	Colour	Pack Piece	Weight kg/100 pc.	Item no.
ISSBP70110RW	Pure white	1	44.600	6290100
ISSBP70110WA	White aluminium	1	16.300	6290104

St Steel

FSK Strip galvanised/powder-coated

Floor plate with 30 mm visible edge and four fastening holes Ø 8.5 mm. The floor plate is suitable for installation the service poles of type ISS70110.

## Rubber support for ISS70110

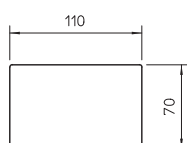

Type	Colour	Pack Piece	Weight kg/100 pc.	Item no.
ISSGU70110	Black	1	5.000	6290170

GUM Rubber

Rubber support for slip-free fixing of the floor-ceiling service pole. The rubber support is suitable for installing on the service poles of type ISS70110.

### Aluminium wall cover, closed, 70110

Type	Colour	Dimension a mm	Dimension b mm	Pack Piece	Weight kg/100 pc.	Item no.
<b>G-AWAG70110RW</b>	Pure white	178	138	1	16.000	<b>6278840</b>

Alu Aluminium

Wall cover, closed, to close wall penetrations during panel mounting. In the respective dimensions, it is also suitable as a ceiling cover for ISS service poles.

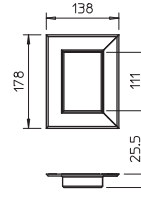

### Partition, trunking height 70 mm

Type	Length mm	Pack m	Weight kg/100 m	Item no.
<b>GA-TW70</b>	2000	2	51.500	<b>6279711</b>

St Steel

Partition to divide the Rapid 80 GA, Rapid IBIS aluminium device installation trunking and ISS service poles for the installation of different voltage levels.

For vertical mounting of device installation trunking and the installation of ISS service poles, the duct clamps, type KL80A, are required for secure fixing of the partition.

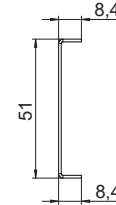

## Service pole, type ISS140110

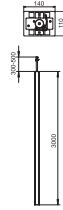

Type	Colour	Surface	Length mm	Pack Piece	Weight kg/100 pc.	Item no.
ISS140110RW	Pure white	—	3,006	1	1,370.000	6288960
ISS140110EL	—	Anodised	3,006	1	1,710.000	6288963

Alu Aluminium

EL Anodised

ISS aluminium service pole with a 76.5 mm system opening.

Set consists of:

1 two-compartment pole with clamping fastening

Total length 3,315–3,480 mm

1 ceiling attachment with clamp

2 aluminium covers

Length: 3,000 mm

The service pole is suitable for accepting front-locking accessory mounting boxes

of the series 71GD... Optionally, a partition, type TW (6288256), and mounting of a cover clip, type KL80A (6288640), are possible.

The service pole is pre-mounted and ready for use immediately. The following accessories can be used, depending on the mounting situation.

## Floor plate for ISS140110

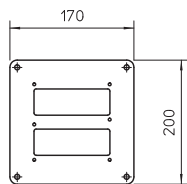

Type	Colour	Pack Piece	Weight kg/100 pc.	Item no.
ISSBP140110RW	Pure white	1	64.600	6290130
ISSBP140110WA	White aluminium	1	64.600	6290134

St Steel

FSK Strip galvanised/powder-coated

Floor plate with 30 mm visible edge and four fastening holes Ø 8.5 mm. The floor plate is suitable for installation the service poles of type ISS140110.

## Rubber support for ISS140110

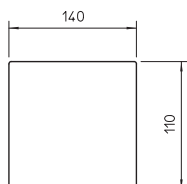

Type	Colour	Pack Piece	Weight kg/100 pc.	Item no.
ISSGU140110	Black	1	9.000	6290176

GUM Rubber

Rubber support for slip-free fastening of the floor-ceiling service pole. The rubber support is suitable for installing on the service poles of type ISS140110.

### Ceiling panel for ISS140110

Type	Colour	Pack	Weight	Item no.
		Piece	kg/100 pc.	
<b>WAG140110RW</b>	Pure white	1	32.000	<b>6290240</b>
<b>Alu</b>	Aluminium			

Ceiling rosette for tidy closure of the pole penetration in the ceiling. Suitable for service pole, type ISS140110.

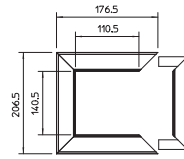

### Partition, trunking height 70 mm

Type	Length	Pack	Weight	Item no.
	mm	m	kg/100 m	
<b>GA-TW70</b>	2000	2	51.500	<b>6279711</b>
<b>St</b>	Steel			

Partition to divide the Rapid 80 GA, Rapid IBIS aluminium device installation trunking and ISS service poles for the installation of different voltage levels. For vertical mounting of device installation trunking and the installation of ISS service poles, the duct clamps, type KL80A, are required for secure fixing of the partition.

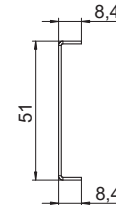

## Service pole, type 130130

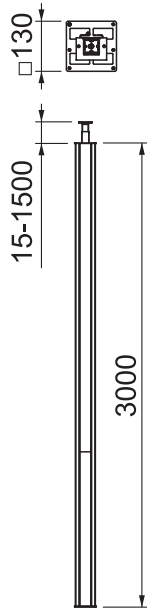

Type	Colour	Surface	Pack	Weight	Item no.
			Piece	kg/100 pc.	
ISS130130RW	Pure white	Anodised	1	100.000	6289407
ISS130130EL	—	Anodised	1	100.000	6289405

Alu Aluminium  
EL Anodised

Aluminium floor/ceiling service pole (surface anodised or powder-coated in RAL 9010) with two 76.5 mm system openings to accommodate accessory mounting boxes in the 71GD... series or for the installation of switching and connection devices.

## Ceiling panel for telescope

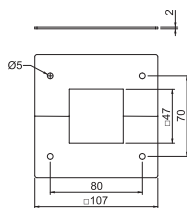

Type	Colour	Pack	Weight	Item no.
		Piece	kg/100 pc.	
DBT130130RW	Pure white	1	10.800	6286820
DBT130130EL	White aluminium	1	10.800	6286821

St Steel

Ceiling rosette for tidy closure of the telescope in the ceiling. Suitable for service pole, type ISS130130.

## Ceiling panel for pole profile

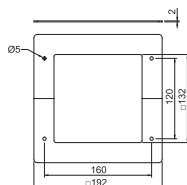

Type	Colour	Pack	Weight	Item no.
		Piece	kg/100 pc.	
DBP130130RW	Pure white	1	22.600	6286825
DBP130130EL	White aluminium	1	22.600	6286826

St Steel

Ceiling rosette for tidy closure of the pole penetration in the ceiling. Suitable for service pole, type ISS130130.



Partition

Type	Colour	Pack	Weight	Item no.
		m	kg/100 m	
<b>TW130130</b>	—	1	53.500	<b>6286835</b>

Steel

Partition for the division of the service pole, type ISS130130, for the installation of different voltage levels.

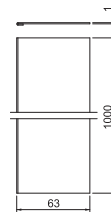

Rubber support

Type	Colour	Pack	Weight	Item no.
		Piece	kg/100 pc.	
<b>ISSGU130130</b>	—	1	7.600	<b>6286839</b>

NBR-SBR Rubber mixture

Rubber support for slip-free fastening of the floor-ceiling service pole, type ISS130130.

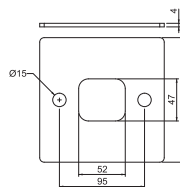

## Service pole, type ISS110100R

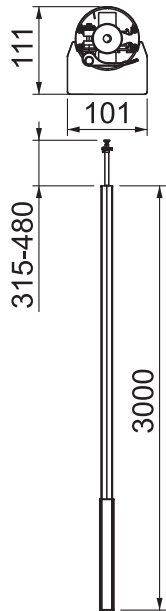

Type	Colour	Surface	Dimension A mm	Dimension B mm	Pack Piece	Weight kg/100 pc.	Item no.
ISS110100RRW	Pure white	—	780	3,000	1	1,000.000	6289060
ISS110100REL	—	Anodised	780	3,000	1	1,000.000	6289063

Alu Aluminium

EL Anodised

ISS aluminium service pole with a thin tube to the ceiling.

Set consists of:

1 single-compartment pole with clamping fastening

Total length 3,315–3,480 mm

1 clamping device for clamping to the ceiling

1 equippable aluminium installation area

Length: 780 mm

In areas for device installation, the service pole has a 76.5 mm

system opening and is suitable for accepting front-locking accessory mounting boxes of the series 71GD...

## Ceiling panel for ISS110100R/ISS140100R

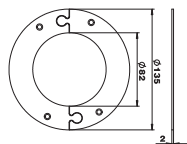

Type	Colour	Pack Piece	Weight kg/100 pc.	Item no.
WAG140100RRW	Pure white	1	14.000	6290290

St Steel

Ceiling rosette for tidy closure of the pole penetration in the ceiling. Suitable for service pole ISS110100R and ISS140100R.

## Floor plate for ISS110100

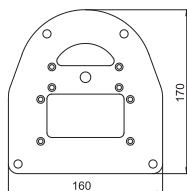

Type	Colour	Pack Piece	Weight kg/100 pc.	Item no.
ISSBP110100RW	Pure white	1	43.600	6290330
ISSBP110100WA	White aluminium	1	43.600	6290331

St Steel

Floor plate to fasten the ISS110100 on the floor. The floor plate with a visible edge has four fastening holes Ø 8.5 mm.

Rubber support for ISS110100R

Type	Colour	Pack Piece	Weight kg/100 pc.	Item no.
ISSGU110100	Black	1	4.500	6290358
GUM	Rubber			

Rubber support for slip-free fastening of the floor-ceiling service pole, type ISS110100.

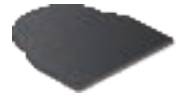
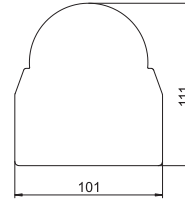

## Service pole, type ISS110100F

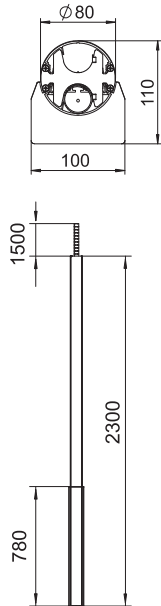

Type	Colour	Surface	Dimension A mm	Dimension B mm	Dimension C mm	Pack Piece	Weight kg/100 pc.	Item no.
ISS110100FRW	Pure white	—	780	2,300	1,500	1	790.000	6289040
ISS110100FEL	—	Anodised	780	2,300	1,500	1	790.000	6289043

Alu Aluminium

EL Anodised

ISS aluminium service pole with a flexible hose to the ceiling.

Set consists of:

1 single-compartment pole with flexible hose to the ceiling

Total length: 2,300 mm

1 flexible hose, length: 1,500 mm

1 equippable aluminium installation compartment

Length: 780 mm

In areas for device installation, the service pole has a 76.5 mm system opening and is suitable for accepting front-locking accessory mounting boxes of the series 71GD... The floor plate as a stand, type SFISSF, and the hose connection to the ceiling, type SAISSF, should be ordered separately (see items below).

## Floor plate for ISSRM45F

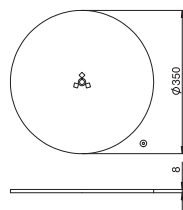

Type	Colour	Pack Piece	Weight kg/100 pc.	Item no.
SFISSFRW	Pure white	1	600.000	6290196
SFISSFWAL	White aluminium	1	600.000	6290197

St Steel

Floor plate as stand for service poles with hose to ceiling, type ISS110100F, 140100F and ISSRM45F.

## Hose connection for ISSRM45F

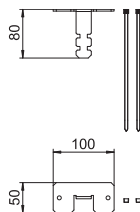

Type	Height mm	Pack Piece	Weight kg/100 pc.	Item no.
SAISSF	80	1	14.000	6290198

St Steel

VZ Galvanised

Hose connection as ceiling attachment for service poles with hose to ceiling, type ISS110100F and 140100F.

Ceiling panel for ISSRM45F

Type	Colour	Pack Piece	Weight kg/100 pc.	Item no.
<b>DAB-F RW</b>	Pure white	1	20.700	<b>6290269</b>

St Steel

Ceiling rosette for tidy closure of the penetration of the flexible hose in the ceiling.

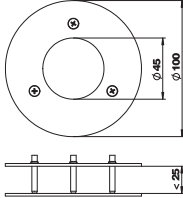

## Service pole, type ISS140100R

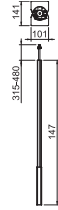

Type	Colour	Surface	Dimension A mm	Dimension B mm	Pack Piece	Weight kg/100 pc.	Item no.
ISS140100RRW	Pure white	—	780	3,000	1	1,390.000	6289070
ISS140100REL	—	Anodised	780	3,000	1	1,390.000	6289073

Alu Aluminium

EL Anodised

ISS aluminium service pole with a thin tube to the ceiling.

Set consists of:

1 two-compartment pole with clamping fastening

Total length 3,315–3,480 mm

1 ceiling attachment with clamp

1 aluminium cover

Length: 780 mm

In areas for device installation, the service pole has a 76.5 mm system opening and is suitable for accepting front-locking accessory mounting boxes of the series 71GD...

## Ceiling panel for ISS110100R/ISS140100R

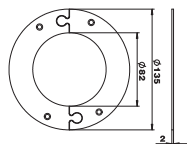

Type	Colour	Pack Piece	Weight kg/100 pc.	Item no.
WAG140100RRW	Pure white	1	14.000	6290290

St Steel

Ceiling rosette for tidy closure of the pole penetration in the ceiling. Suitable for service pole ISS110100R and ISS140100R.

## Floor plate for ISS140100R

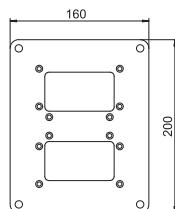

Type	Colour	Pack Piece	Weight kg/100 pc.	Item no.
ISSBP140100RW	Pure white	1	57.200	6290336
ISSBP140100WA	White aluminium	1	57.200	6290337

St Steel

Floor plate to fasten the ISS140100 on the floor. The floor plate with a visible edge has four fastening holes Ø 8.5 mm.

Rubber support for ISS140100R

Type	Colour	Pack Piece	Weight kg/100 pc.	Item no.
ISSGU140100	Black	1	6.500	6290362
GUM	Rubber			

Rubber support for slip-free fastening of the floor-ceiling service pole, type ISS140100.

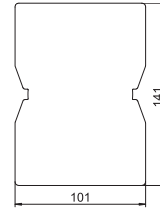

## Service pole, type ISS140100F

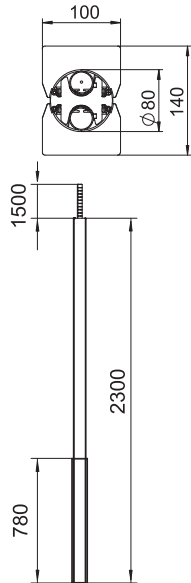

Type	Colour	Surface	Dimension A mm	Dimension B mm	Dimension C mm	Pack Piece	Weight kg/100 pc.	Item no.
ISS140100FRW	Pure white	—	780	2,300	1,500	1	1,100.000	6289050
ISS140100FEL	—	Anodised	780	2,300	1,500	1	1,100.000	6289053

Alu Aluminium

EL Anodised

ISS aluminium service pole with a flexible hose to the ceiling.

Set consisting of:

1 two-compartment pole with 2 flexible hoses to the ceiling

Total length of the aluminium profile: 2,300 mm

2 flexible hoses, length: 1,500 mm

2 aluminium covers

Length: 780 mm

In areas for device installation, the service pole has a 76.5 mm system opening and is suitable for accepting front-locking accessory mounting boxes of the series 71GD... The floor plate as a stand, type SFISSF, and the hose connection to the ceiling, type SAISSF, should be ordered separately (see articles below).

## Floor plate for ISSRM45F

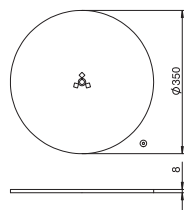

Type	Colour	Pack Piece	Weight kg/100 pc.	Item no.
SFISSFRW	Pure white	1	600.000	6290196
SFISSFWAL	White aluminium	1	600.000	6290197

St Steel

Floor plate as stand for service poles with hose to ceiling, type ISS110100F, 140100F and ISSRM45F.

## Hose connection for ISSRM45F

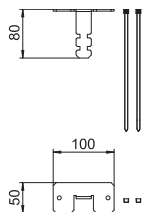

Type	Height mm	Pack Piece	Weight kg/100 pc.	Item no.
SAISSF	80	1	14.000	6290198

St Steel

VZ Galvanised

Hose connection as ceiling attachment for service poles with hose to ceiling, type ISS110100F and 140100F.



Ceiling panel for ISSDM45F

Type	Colour	Pack Piece	Weight kg/100 pc.	Item no.
<b>DAB-2F</b>	Pure white	1	27.100	<b>6290382</b>
<b>St</b>	Steel			

Ceiling rosette for tidy closure of the penetration of the flexible hoses in the ceiling.

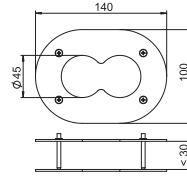

## Service pole, type ISSRM45

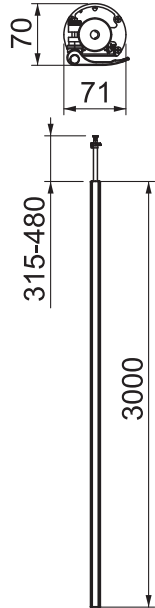

Type	Colour	Surface	Length mm	Pack Piece	Weight kg/100 pc.	Item no.
ISSRM45RW	Pure white	—	3,006	1	510.000	6290086
ISSRM45EL	—	Anodised	3,006	1	510.000	6290087

Alu Aluminium

EL Anodised

ISS aluminium service pole with a 45 mm system opening.

Set consists of:

1 one-compartment pole with clamping fastening

Total length: 3,315 mm–3,480 mm

1 ceiling attachment with clamping device

1 aluminium cover

Length 3,000 mm

The design of this ISS service pole is based on an extremely slender, round aluminium profile, which has a smooth cover of the Rapid 45 device installation trunking series as its front side. The 45 mm system opening is suitable for direct acceptance of Modul 45® switching and connection devices.

## Rubber support for ISSRM45

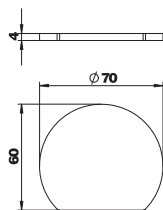

Type	Colour	Pack Piece	Weight kg/100 pc.	Item no.
ISSRGU	Black	1	1.450	6290178

GUM Rubber

Rubber support for slip-free fastening of the floor-ceiling service pole ISSRM45.

## Ceiling panel for ISSRM45

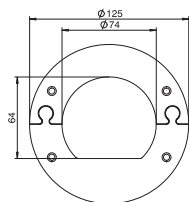

Type	Colour	Pack Piece	Weight kg/100 pc.	Item no.
WAGRM45	Pure white	1	12.900	6290264

St Steel

Closed ceiling rosette for tidy closure of the ceiling gland of the service poles, type ISSRM45.

Partition for trunking height 40 mm

Type	Colour	Length mm	Pack m	Weight kg/100 m	Item no.
2371 40	Light grey	2000	60	13.500	6023096

PVC Polyvinylchloride

Partition to divide the WDK trunking, with 40 mm trunking height, and various ISS service poles for the installation of different voltage levels.

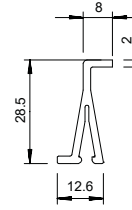

## Service pole, type ISSRM45F

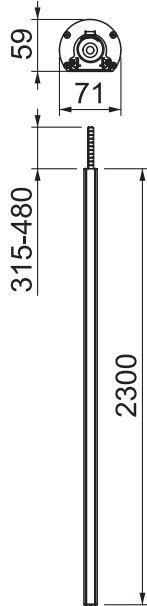

Type	Colour	Surface	Length mm	Pack Piece	Weight kg/100 pc.	Item no.
ISSRM45FRW	Pure white	—	2,306	1	380.000	6290095
ISSRM45FEL	—	Anodised	2,306	1	380.000	6290097

Alu Aluminium

EL Anodised

ISS aluminium service pole with a flexible hose to the ceiling and a 45 mm system opening.

Set consisting of:

1 one-compartment pole with flexible hose to ceiling

Total length: 2,300 mm

1 flexible hose, length: 1,500 mm

1 aluminium cover

Length: 2,300 mm

The design of this ISS service pole is based on an extremely slender, round aluminium profile, which has a smooth cover of the Rapid 45 device installation trunking series as its front side. The 45 mm system opening is suitable for direct acceptance of Modul 45® switching and connection devices.

The floor plate as a stand, type SFISSF, and the hose connection to the ceiling, type SAISSF, should be ordered separately (see articles below).

## Floor plate for ISSRM45F

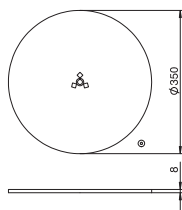

Type	Colour	Pack Piece	Weight kg/100 pc.	Item no.
SFISSFRW	Pure white	1	600.000	6290196
SFISSFWAL	White aluminium	1	600.000	6290197

St Steel

Floor plate as stand for service poles with hose to ceiling, type ISS110100F, 140100F and ISSRM45F.

## Hose connection for ISSRM45F

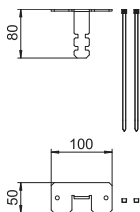
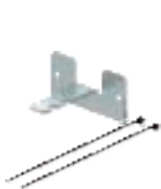

Type	Height mm	Pack Piece	Weight kg/100 pc.	Item no.
SAISSF	80	1	14.000	6290198

St Steel

VZ Galvanised

Hose connection as ceiling attachment for service poles with hose to ceiling, type ISS110100F and 140100F.

### Ceiling panel for ISSRM45F

Type	Colour	Pack Piece	Weight kg/100 pc.	Item no.
<b>DAB-F RW</b>	Pure white	1	20.700	<b>6290269</b>
<b>St</b> Steel				

Ceiling rosette for tidy closure of the penetration of the flexible hose in the ceiling.

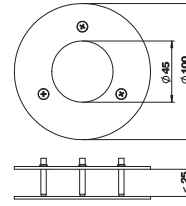

### Partition for trunking height 40 mm

Type	Colour	Length mm	Pack m	Weight kg/100 m	Item no.
<b>2371 40</b>	Light grey	2,000	60	13.500	<b>6023096</b>
<b>PVC</b> Polyvinylchloride					

Partition to divide the WDK trunking, with 40 mm trunking height, and various ISS service poles for the installation of different voltage levels.

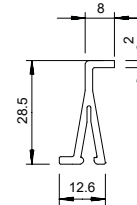

## Service pole, type ISSDM45

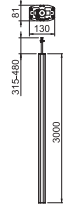

Type	Colour	Surface	Length mm	Pack Piece	Weight kg/100 pc.	Item no.
<b>ISSDM45RW</b>	Pure white	—	3,009	1	1,172.000	<b>6289970</b>
<b>ISSDM45EL</b>	—	Anodised	3,009	1	1,172.000	<b>6289972</b>

**Alu** Aluminium

**EL** Anodised

ISS aluminium service pole with a 45 mm system opening.

Set consisting of:

1 two-compartment pole with clamping fastening

Total length: 3,315–3,480 mm

1 ceiling attachment with clamp

2 aluminium covers, length 3,000 mm

The clamp which is attached to the top of the ISS service pole can be variably adjusted from 300 to 500 mm. Possible colour options are aluminium anodised or pure white. The pole is based on a slender, oval aluminium profile. There are two 45 mm system openings on opposite sides for direct installation of Module 45® devices.

## Rubber support for ISSDM45R

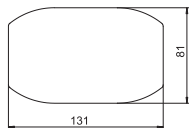

Type	Colour	Pack Piece	Weight kg/100 pc.	Item no.
<b>ISSGUDM45</b>	<b>Black</b>	1	4.600	<b>6290372</b>

**GUM** Rubber

Rubber support for slip-free fastening of the floor-ceiling service pole, type ISSDM45.

## Ceiling panel for ISSDM45R

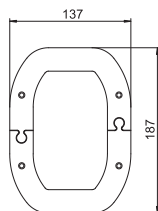

Type	Colour	Pack Piece	Weight kg/100 pc.	Item no.
<b>WAGDM45</b>	Pure white	1	46.800	<b>6290387</b>

**St** Steel

Ceiling rosette for tidy closure of the pole penetration, type ISSDM45, in the ceiling.

### Floor plate for ISSDM45

Type	Colour	Pack Piece	Weight		Item no.
			kg/100 pc.		
ISSBPDM45RW	Pure white	1	39.000		6290347
ISSBPDM45WA	White aluminium	1	39.000		6290348

St Steel

Floor plate with 30 mm visible edge and four fixing holes Ø 8.5 mm.

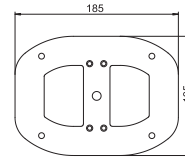

### Partition for trunking height 40 mm

Type	Colour	Length mm	Pack m	Weight		Item no.
				kg/100 m		
2371 40	Light grey	2,000	60	13.500		6023096

PVC Polyvinylchloride

Partition to divide the WDK trunking, with 40 mm trunking height, and various ISS service poles for the installation of different voltage levels.

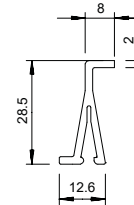

## Service pole, type ISSDM45F

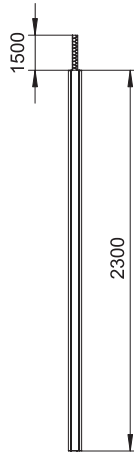
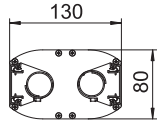

Type	Colour	Surface	Length mm	Pack Piece	Weight kg/100 pc.	Item no.
ISSDM45FRW	Pure white	—	2,306	1	871.000	6289974
ISSDM45FEL	—	Anodised	2,306	1	871.000	6289976

Alu Aluminium

EL Anodised

ISS aluminium service pole with a 45 mm system opening.

Set consists of:

1 two-compartment pole with two flexible hoses to the ceiling

Total length of the aluminium profile: 2,300 mm

2 aluminium covers, length 2,300 mm

Colour options are pure white or aluminium anodised. There are two 45 mm system openings on opposite sides for direct installation of Module 45® devices. The floor plate as a stand, type SFISSF, and the hose connection to the ceiling, type SAISSF, should be ordered separately (see articles below).

## Floor plate for ISSRM45F

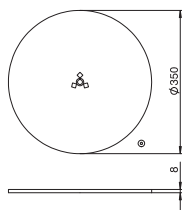

Type	Colour	Pack Piece	Weight kg/100 pc.	Item no.
SFISSFRW	Pure white	1	600.000	6290196
SFISSFWAL	White aluminium	1	600.000	6290197

St Steel

Floor plate as stand for service poles with hose to ceiling, type ISS110100F, 140100F and ISSRM45F.

## Hose connection for ISSRM45F

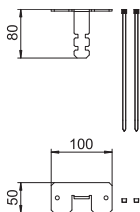

Type	Height mm	Pack Piece	Weight kg/100 pc.	Item no.
SAISSF	80	1	14.000	6290198

St Steel

VZ Galvanised

Hose connection as ceiling attachment for service poles with hose to ceiling, type ISS110100F and 140100F.



### Ceiling panel for ISSDM45F

Type	Colour	Pack Piece	Weight kg/100 pc.	Item no.
<b>DAB-2F</b>	Pure white	1	27.100	<b>6290382</b>
<b>St</b> Steel				

Ceiling rosette for tidy closure of the penetration of the flexible hoses in the ceiling.

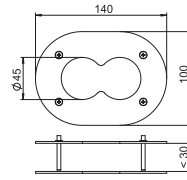

### Partition for trunking height 40 mm

Type	Colour	Length mm	Pack m	Weight kg/100 m	Item no.
<b>2371 40</b>	Light grey	2,000	60	13.500	<b>6023096</b>
<b>PVC</b> Polyvinylchloride					

Partition to divide the WDK trunking, with 40 mm trunking height, and various ISS service poles for the installation of different voltage levels.

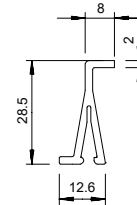

### Accessory mounting box, single

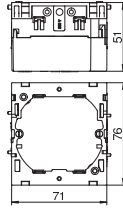

Type	Colour	Pack Weight		Item no.
		Piece	kg/100 pc.	
<b>71GD6</b>	Iron grey	5	5.600	<b>6288610</b>
<b>PA</b> Polyamide				

Front locking accessory mounting box for switch systems, with folding, and also removable, base for time-saving cable connection, with feed openings for cable diameters of up to 14 mm. Halogen-free version.

### Accessory mounting box, double

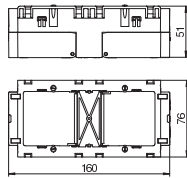

Type	Colour	Pack Weight		Item no.
		Piece	kg/100 pc.	
<b>71GD7</b>	Iron grey	2	11.000	<b>6288611</b>
<b>PA</b> Polyamide				

Front locking accessory mounting box for standard switch ranges for the installation of two individual installation devices or a multiple protective contact socket. With unfolding, and also removable, base for time-saving cable connection and with feed openings for cable diameters of up to 14 mm. Halogen-free version.

### Accessory mounting box, single, for Modul 45®

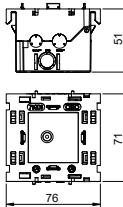

Type	Colour	Pack Weight		Item no.
		Piece	kg/100 pc.	
<b>71GD8-2</b>		1	5.900	<b>6288569</b>
<b>PA</b> Polyamide				

Front locking single accessory mounting box for Modul 45® system, with folding, and also removable, base for time-saving cable connection, with feed openings for cable diameters of up to 14 mm.

### Accessory mounting box, double, for Modul 45®

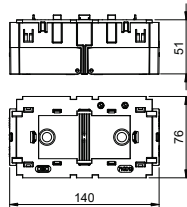

Type	Colour	Pack Weight		Item no.
		Piece	kg/100 pc.	
<b>71GD13</b>		1	11.000	<b>6288583</b>
<b>PA</b> Polyamide				

Front locking double accessory mounting box for Modul 45® system, with folding, and also removable, base for time-saving cable connection, with feed openings for cable diameters of up to 14 mm.

### Accessory mounting box, triple, for Modul 45®

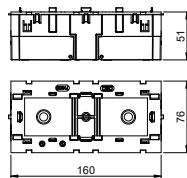

Type	Colour	Pack Weight		Item no.
		Piece	kg/100 pc.	
<b>71GD9-2</b>		1	11.600	<b>6288579</b>
<b>PA</b> Polyamide				

Front locking triple accessory mounting box for Modul 45® system, with folding, and also removable, base for time-saving cable connection, with feed openings for cable diameters of up to 14 mm.

### Clamping device

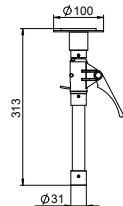

Type	Colour	Pack Weight		Item no.
		Piece	kg/100 pc.	
<b>ISSDV</b>	—	1	70.000	<b>6290189</b>

Clamping device for tensioning the floor-ceiling service poles against the ceiling. The area for height adjustment lies between 313 mm (basis length) and 480 mm.

### Draw-in tool

Type	Colour	Pack Piece	Weight kg/100 pc.	Item no.
<b>HAT30</b>	Blue	1	3.600	<b>6290201</b>
PA Polyamide				

Tool for reassignment of the flexible hose for service poles of the ...F series.

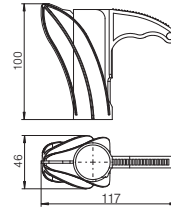

### Protective conductor connection bracket

Type	Surface	Pack Piece	Weight kg/100 pc.	Item no.
<b>8AWR</b>	Electrogalvanised	10	0.610	<b>6288704</b>
St Steel				
G Electrogalvanised				

Protective conductor connection bracket to include steel and aluminium device installation trunking, service poles and system components of underfloor trunking systems in the protective measure.

Clamping area: 2 x 1.5–4 mm<sup>2</sup>

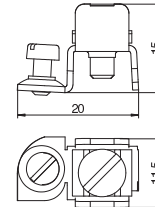

### Locking bracket

Type	Pack Piece	Weight kg/100 pc.	Item no.
<b>RKV3V</b>	20	0.085	<b>6288700</b>
St Steel			

Locking bracket for the mechanical and electrical connection of trunking covers and trunking bases. Suitable for covers of Rapid 45, Rapid 80 and ISS systems.



## Service pole, type ISSHS4



Type	Colour	Number of compartments	Pack Piece	Weight kg/100 pc.	Item no.
ISSHS4 61OT3RW	Pure white	4	1	1,050.000	6286700
ISSHS4 61OT3LGR	Light grey	4	1	1,108.000	6286702

St Steel

ISS sheet steel service pole with a 76.5 mm system opening on four sides. Empty, fittable from all four sides with six standard devices (socket, telephone, etc.) on each side, max. 24 devices. Fastening possible directly on the floor. Accessory mounting boxes to be ordered separately. The service pole is suitable for accepting front locking accessory mounting boxes of the series 71GD....

## Protective frame for ISSHS4

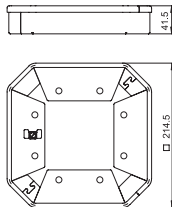

Type	Colour	Pack Piece	Weight kg/100 pc.	Item no.
ISSHS4SR40	Jet black	1	69.400	6286810

St Steel

Protective frame for ISSHS4 service pole for mechanical protection of the columns in the foot area.

## Service pole, type ISSHS140250

Type	Colour	Surface	Number of compartments St.	Pack Piece	Weight kg/100 pc.	Item no.
ISSHS140250RW	Pure white	—	2	1	175.000	6290020
ISSHS140250EL	—	Anodised	2	1	175.000	6290023

Alu Aluminium

EL Anodised

ISS aluminium service pole, 2-compartment, with a 76.5 mm system opening.  
Empty, equippable with standard devices (socket, telephone, etc.), max. 4 devices.  
Direct fastening on floor possible. Accessory mounting boxes to be ordered separately.  
The service pole is suitable for accepting front locking accessory mounting boxes of the series 71GD.... The installation of a partition of type GA-TW (6279711) and the installation of the cover clip, type KL80A, are possible as an option.

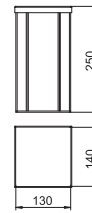

## Service pole, type ISSHS140500

Type	Colour	Surface	Number of compartments St.	Pack Piece	Weight kg/100 pc.	Item no.
ISSHS140500RW	Pure white	—	2	1	302.000	6290030
ISSHS140500EL	Aluminium	Anodised	2	1	354.800	6290033

Alu Aluminium

EL Anodised

ISS aluminium service pole, 2-compartment, with a 76.5 mm system opening.  
Empty, equippable with standard devices (socket, telephone, etc.), max. 8 devices.  
Direct fastening on floor possible. Accessory mounting boxes to be ordered separately.  
The service pole is suitable for accepting front locking accessory mounting boxes of the series 71GD.... The installation of a partition of type GA-TW (6279711) and the installation of the cover clip, type KL80A, are possible as an option.



## Service pole, type ISSHS140700

Type	Colour	Surface	Number of compartments St.	Pack Piece	Weight kg/100 pc.	Item no.
ISSHS140700RW	Pure white	—	2	1	466.000	6290040
ISSHS140700EL	Aluminium	Anodised	2	1	466.000	6290043

Alu Aluminium

EL Anodised

ISS aluminium service pole, 2-compartment, with a 76.5 mm system opening.  
Empty, equippable with standard devices (socket, telephone, etc.), max. 10 devices.  
Direct fastening on floor possible. Accessory mounting boxes to be ordered separately.  
The service pole is suitable for accepting front locking accessory mounting boxes of the series 71GD.... The installation of a partition of type GA-TW (6279711) and the installation of the cover clip, type KL80A, are possible as an option.



## Service pole, type ISSOGHS70140

Type	Colour	Surface	Pack Piece	Weight kg/100 pc.	Item no.
ISSOGHS70140EL	—	Anodised	1	220.500	6289096
ISSOGHS70140RW	Pure white	—	1	220.500	6289098

Alu Aluminium

EL Anodised

ISS aluminium service pole with a 76.5 mm system opening.  
Set consists of:

- 1 single-compartment pole with stand  
Total length: 675 mm
- 1 aluminium cover  
Length: 675 mm

The design of this ISS service pole is based on the oval-shaped aluminium profile of ISSOG70140 floor-ceiling poles. The 76.5 mm system opening is suitable for directly accepting mounting box accessories of series 71GD... for the equipment with switching and connection devices.

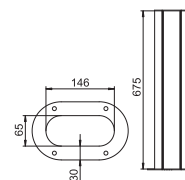

## Service pole, type ISSHS6

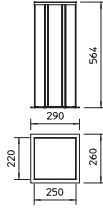

Type	Colour	Surface	Number of compartments St.	Pack Piece	Weight kg/100 pc.	Item no.
<b>ISSHS6EL</b>	—	Anodised	6	1	720.000	<b>6290073</b>
<b>Alu</b>	Aluminium					
<b>EL</b>	Anodised					

ISS service pole centre.

Empty, can be equipped from all four sides with standard devices (socket, telephone, etc.). Two sides of the installation centre can be equipped in two compartments, the other two sides in one. Each installation compartment can accept 5 devices, the entire installation centre accepts max. 30 devices. Direct fastening on floor possible. Accessory mounting boxes to be ordered separately. The service pole is suitable for accepting front locking accessory mounting boxes of the series 71GD.... The installation of a partition of type GA-TW (6279711) and the installation of the cover clip, type KL80A, are possible as an option.

## Service pole, type ISSRHSM45

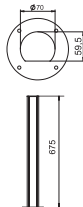

Type	Colour	Surface	Number of compartments St.	Pack Piece	Weight kg/100 pc.	Item no.
<b>ISSRHSM45RW</b>	Pure white	—	1	1	135.000	<b>6290090</b>
<b>ISSRHSM45EL</b>	—	Anodised	1	1	135.000	<b>6290091</b>
<b>Alu</b>	Aluminium					
<b>EL</b>	Anodised					

ISS aluminium service pole with a 45 mm system opening.

Set consists of:

1 one-compartment pole with stand

Total length: 670 mm

1 aluminium cover

Length: 670 mm

The design of this ISS service pole is based on an extremely slender, round aluminium profile, which has a smooth cover of the Rapid 45 device installation trunking series as its front side. The 45 mm system opening is suitable for direct acceptance of Modul 45® switching and connection devices. The installation compartment is theoretically sufficient for 14 Modul 45® devices. If Modul 45connect® is used or in the case of cabling requiring a lot of space, the number of the max. installable devices is reduced. There is the option to install a partition, type 2371/40 (6023096).

## Service pole, type ISSDHSM45

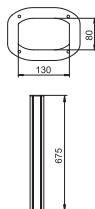

Type	Colour	Surface	Pack Piece	Weight kg/100 pc.	Item no.
<b>ISSDHSM45RW</b>	Pure white	—	1	281.500	<b>6289980</b>
<b>ISSDHSM45EL</b>	—	Anodised	1	281.500	<b>6289982</b>
<b>Alu</b>	Aluminium				
<b>EL</b>	Anodised				

ISS service pole made from aluminium with 45 mm system opening for the direct installation of Modul 45 switching and connection devices.

Pole consists of:

1 two-compartment pole with stand

Total length 670 mm

2 aluminium covers

Length 670 mm

The design of this service pole is based on an extremely narrow, oval aluminium profile which shows on both narrow sides of the oval a cover of the Rapid 45 device installation trunking series. The 45 mm system opening is suitable for direct acceptance of Modul 45® switching and connection devices. The installation area is theoretically sufficient for 2 x 14 Modul 45® devices. If Modul 45connect® is used or in the case of cabling requiring a lot of space, the number of the max. installable devices is reduced. There is the option to install a partition, type 2371/40 (6023096).

### Accessory mounting box, single

Colour		Pack	Weight	Item no.
Type	Piece	kg/100 pc.		
<b>71GD6</b>	Iron grey	5	5.600	<b>6288610</b>
<b>PA</b>	Polyamide			

Front locking accessory mounting box for switch systems, with folding, and also removable, base for time-saving cable connection, with feed openings for cable diameters of up to 14 mm. Halogen-free version.

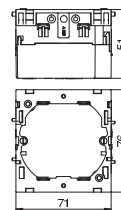

### Accessory mounting box, double

Colour		Pack	Weight	Item no.
Type	Piece	kg/100 pc.		
<b>71GD7</b>	Iron grey	2	11.000	<b>6288611</b>
<b>PA</b>	Polyamide			

Front locking accessory mounting box for standard switch ranges for the installation of two individual installation devices or a multiple protective contact socket. With unfolding, and also removable, base for time-saving cable connection and with feed openings for cable diameters of up to 14 mm. Halogen-free version.

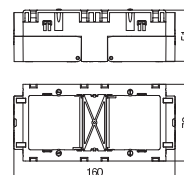

### Accessory mounting box, single, for Modul 45®

Colour		Pack	Weight	Item no.
Type	Piece	kg/100 pc.		
<b>71GD8-2</b>	Iron grey	1	5.900	<b>6288569</b>
<b>PA</b>	Polyamide			

Front locking single accessory mounting box for Modul 45® system, with folding, and also removable, base for time-saving cable connection, with feed openings for cable diameters of up to 14 mm.

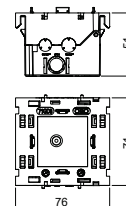

### Accessory mounting box, double, for Modul 45®

Colour		Pack	Weight	Item no.
Type	Piece	kg/100 pc.		
<b>71GD13</b>	Iron grey	1	11.000	<b>6288583</b>
<b>PA</b>	Polyamide			

Front locking double accessory mounting box for Modul 45® system, with folding, and also removable, base for time-saving cable connection, with feed openings for cable diameters of up to 14 mm.

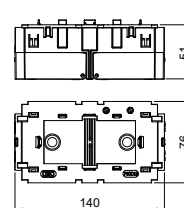

### Accessory mounting box, triple, for Modul 45®

Colour		Pack	Weight	Item no.
Type	Piece	kg/100 pc.		
<b>71GD9-2</b>	Iron grey	1	11.600	<b>6288579</b>
<b>PA</b>	Polyamide			

Front locking triple accessory mounting box for Modul 45® system, with folding, and also removable, base for time-saving cable connection, with feed openings for cable diameters of up to 14 mm.

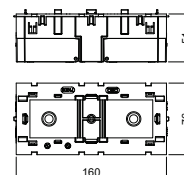

### Protective conductor connection bracket

Surface		Pack	Weight	Item no.
Type	Piece	kg/100 pc.		
<b>8AWR</b>	Electrogalvanised	10	0.610	<b>6288704</b>
<b>St</b>	Steel			
<b>G</b>	Electrogalvanised			

Protective conductor connection bracket to include steel and aluminium device installation trunking, service poles and system components of underfloor trunking systems in the protective measure.

Clamping area: 2 x 1.5–4 mm<sup>2</sup>

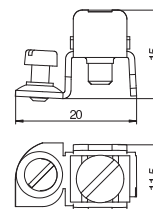

## Locking bracket

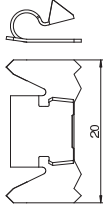

Type  
**RKV3V**

SI Steel

Locking bracket for the mechanical and electrical connection of trunking covers and trunking bases. Suitable for covers of Rapid 45, Rapid 80 and ISS systems.

Pack	Weight	Item no.
Piece	kg/100 pc.	
20	0.085	<b>6288700</b>





OBO Bettermann Holding GmbH & Co. KG  
P.O. Box 1120  
58694 Menden  
GERMANY

**Customer Service Germany**  
Tel.: +49 23 73 89 - 17 00  
Fax: +49 23 73 89 - 12 38  
[export@obo.de](mailto:export@obo.de)

[www.obo-bettermann.com](http://www.obo-bettermann.com)

---

**Building Connections**

